

# SPECIAL CUSTOMIZED HANDLING EQUIPMENT

BELET a.s. , Dělnická 1253/37, 431 91 VEJPRTY, CZECH REPUBLIC

tel: +420 474 386 333, +420 474 386 381, +420 604 225 110

email: beletvejprty@belet.cz, odbyt@belet.cz

http://www.belet.cz



## SPECIAL LOADERS FOR HANDLING WITH OVERSIZED AND HEAVY LOADS

- Multi-purpose driving unit enabling use for both high lift trucks and also for pallet trucks according to customer requirements
- Design of the mast on the principle of a modular character with the option of adding integrated forks and other special attachments such as push/pull system for molds, clamps for rolls or with platform for the transport of loads.

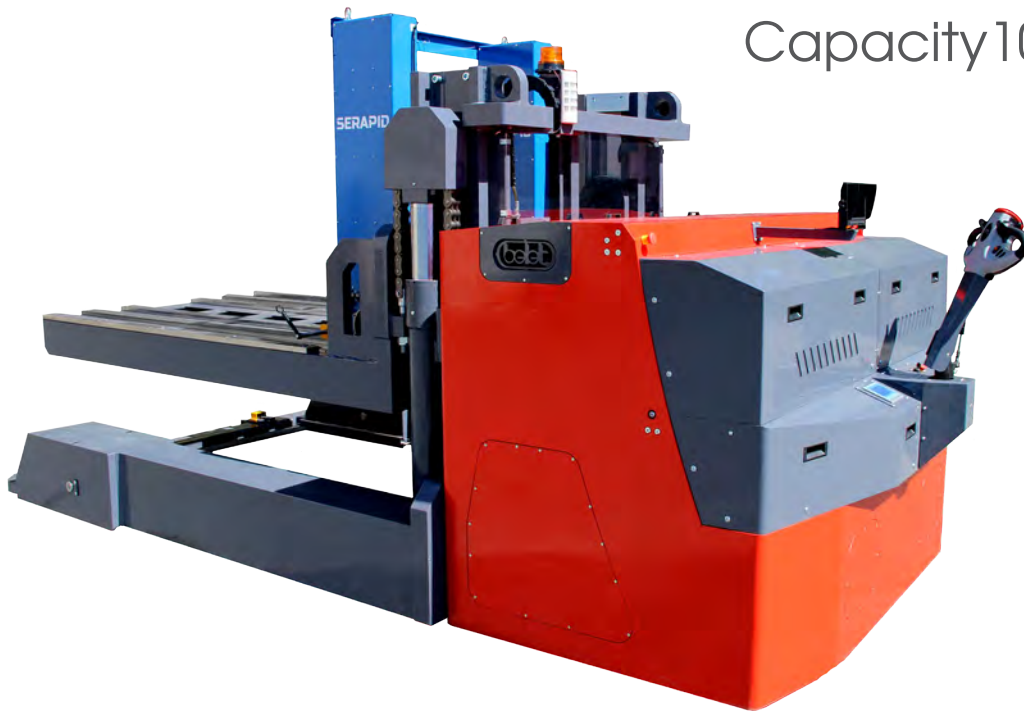

Capacity 10.000 - 20.000kg

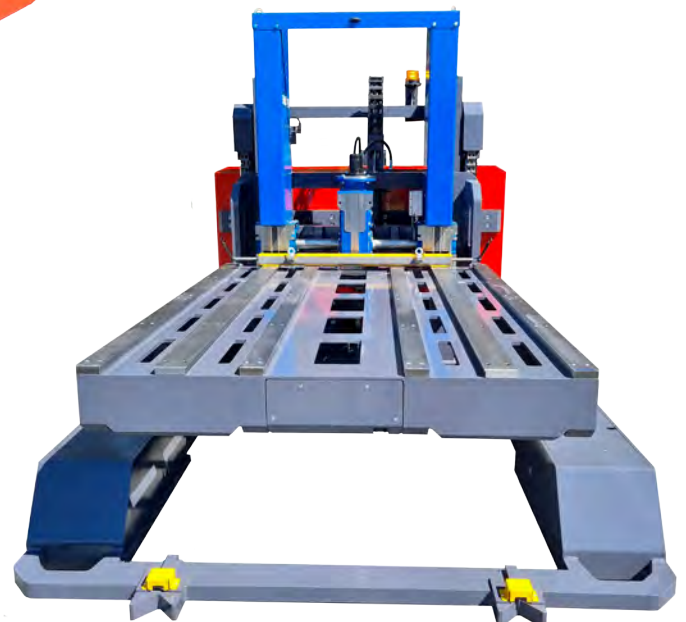
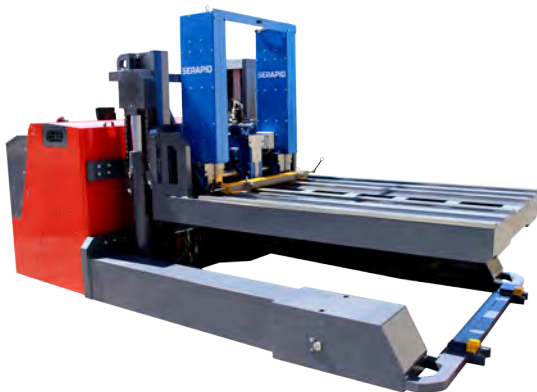

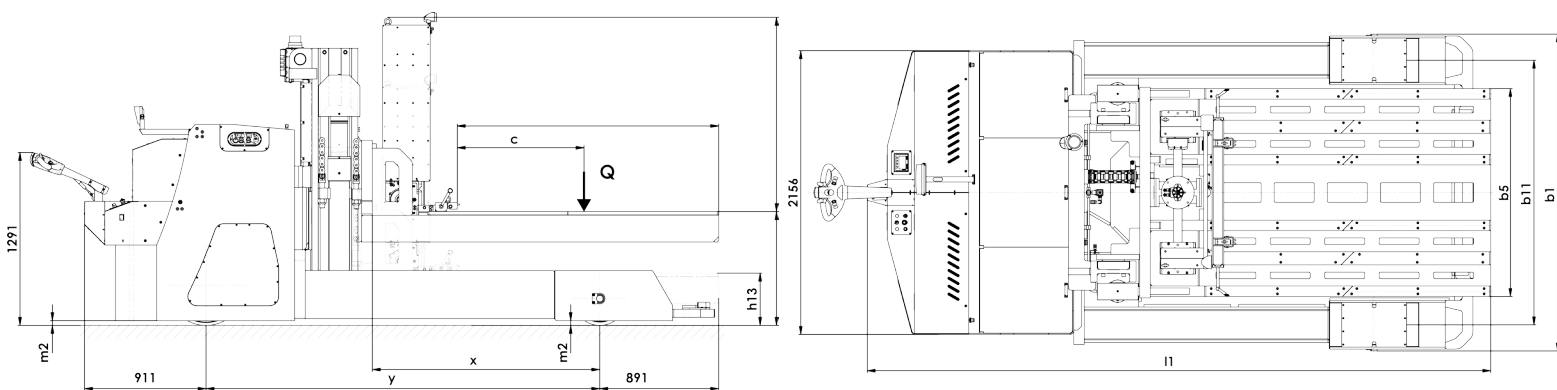

## Basic technical parameters

**BF 150B2M**

<b>Identification</b>	1.1	Producer	BELET a.s.	
	1.2	Type	BF 150B2M12/QDX	
	1.3	Drive motor	electric	
	1.5	Load capacity	Q (kg)	15.000
	1.6	Load centre distance	c (mm)	900
	1.8	Distance between driving axle to forks	x (mm)	1704
	1.9	Wheel base centre	y (mm)	2950
<b>Wheels</b>	3.1	Tyres	Vulkolan	
	3.2	Wheels dimensions	(mm)	∅ 400x125
	3.3	Front wheel dimension	(mm)	∅ 600x200
	3.5	Number of front/back wheels	ks	2 + 2 / x 2
	3.6	Track width additional wheels	b10 (mm)	1250
	3.7	Track width	b11 (mm)	2187 / 1833
	<b>Dimensions</b>	4.15	Min. fork height	h13 (mm)
4.19		Overall length	l1 (mm)	4716
4.20		Length to fork face	l2 (mm)	2121
4.21		Overall width	b1 (mm)	2408
4.22		Fork dimensions	s/e/l (mm)	227 / 1580 / 2595
4.25		Overall fork width	b5 (mm)	1580
4.32		Ground clearance , centre of wheel base	m2 (mm)	35
4.34		Working aisle with pallet 800x1200 lengthwise	ast (mm)	3500
4.35		Turning radius	wa (mm)	3860
4.4		Lifting height	h13 (mm)	1200 - 4000
<b>Performance</b>	5.1	Driving speed with/without load	km/h	3/5
	5.2	Lifting speed with/ without load	m/s	10,20 / 11,93
	5.3	Lowering speed with/without load	m/s	12,50 / 10,80
	5.8	Max. performance with/ without load	%	3/5
	5.10	Service brake		electromagnetic
<b>Motor</b>	6.1	Drive motor	kw	2 x 7
	6.2	Lift motor	kw	8
	6.4	Battery	V/Ah	2 x 48/480
	6.5	Battery service weight	kg	2 x 368
		Battery size	L/P/H (mm)	560 / 610 x 460
	8.1	Driving control type		electronic