

# ELECTRIC STACKER FOR LIGHT-DUTY APPLICATIONS

BELET a.s. , Dělnická 1253/37, 431 91 VEJPRTY, CZECH REPUBLIC

tel: +420 474 386 333, +420 474 386 381, +420 604 225 110

email: beletvejprty@belet.cz, odbyt@belet.cz

http://www.belet.cz



## FX 12APE20/Lio

## FX 12APE29/Lio

## FX 12APE36/Lio



The tiller is made of high strength polyamide with 30% glass fibre material



- Ideal for light duty applications
- Compact and low service weight
- High manoeuvrability
- Li-ion battery with fast charging
- Integrated 25A charger
- BMS - Battery Management System

Capacity 1 200kg

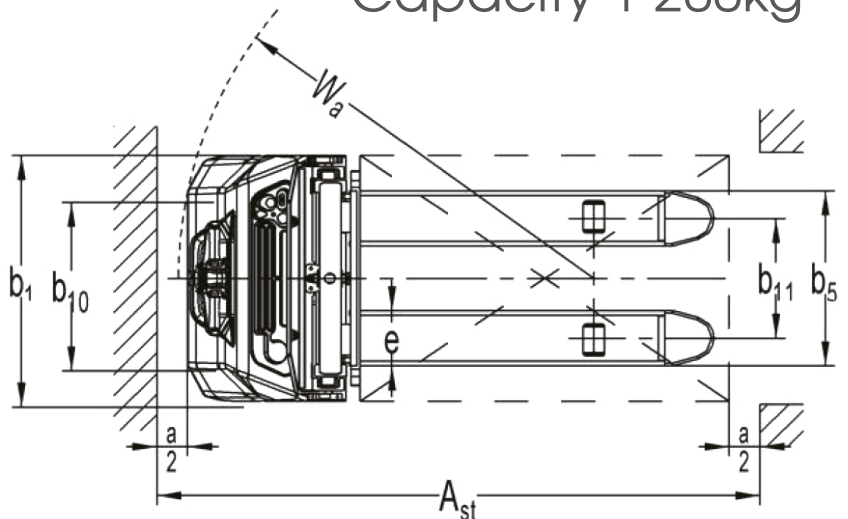
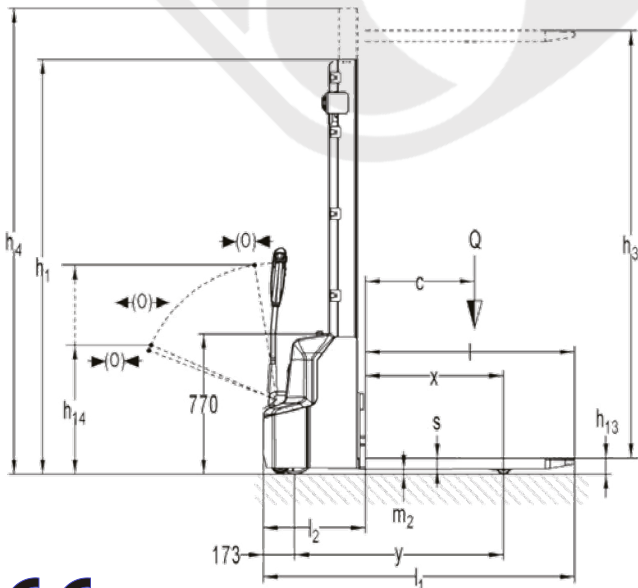

# ELECTRIC STACKER FOR LIGHT-DUTY APPLICATIONS

BELET a.s. , Dělnická 1253/37, 431 91 VEJPRTY, CZECH REPUBLIC

tel: +420 474 386 333, +420 474 386 381, +420 604 225 110

email: beletvejprty@belet.cz, odbyt@belet.cz

http://www.belet.cz



Technical specification		FX 12APE20/Lio	FX 12APE29/Lio	FX 12APE36/Lio	
Identification	1.3 Drive motor	electric			
	1.4 Steering method	walking			
	1.5 Load Capacity / rated load	Q(Kg)	1200		
	1.6 Load centre distance	c (mm)	600		
	1.8 Distance between driving axle to fork	x(mm)	760		
	1.9 Wheel base centre	y(mm)	1147		
Weights	2.1 Service weight	kg	585		
	2.2 Axle load loaded drive end / load end	kg	560 / 1225		
	2.3 Axle load unloaded drive end / load end	kg	440 / 145		
Wheels, Chassis	3.1 Tyres	polyurethan			
	3.2 Front wheels dimensions	(mm)	210 x 75		
	3.3. Back wheels dimensions	(mm)	84 x 93		
	3.4 Additional wheels (dimensions)	(mm)	100 x 50		
	3.5 Number of front / back wheels		1x 1/2		
	3.6 Track width, front	b10(mm)	550		
	3.7 Track width, rear	b11(m)m	400 / 515		
Dimensions	4.2 Height mast lowered	h1(mm)	2330	1930	2280
	4.4 Lifting height	h3(mm)	1914	2814	3514
	4.9 Handle height in driving position min./max	h14(mm)	710 / 1150		
	4.15 Min. fork height	h13(mm)	86		
	4.19 Overall length	l1(mm)	1710		
	4.20 Length to fork face	l2(mm)	560		
	4.21 Overall width	b1(mm)	800		
	4.22 Fork dimensions	s/e/l(mm)	60 / 180 / 1150		
	4.25 Overall fork width	b5(mm)	570		
	4.32 Ground clearance, centre of wheel base	m2(mm)	26		
	4.34 Working aisle with pallet 800X1200 lengthwise	Ast(mm)	2145		
4.35 Turning radius	Wa(mm)	1350			
Performance	5.1 Driving speed with load / without load	km/h	4.5 / 4.7		
	5.2 Lifting speed with load / without load	m/s	0.11 / 0.14		
	5.3 Lowering speed with load / without load	m/s	0.13 / 0.11		
	5.8 Max. performance with load / without load	%	5 / 10		
	5.10 Service brake		electromagnetic		
Motor	6.1 Drive motor rating s2 60min	kW	0.65		
	6.2 Lift motor rating s3 15%	kW	2.2		
	6.4 Battery voltage, nominal capacity	V/Ah	24 / 60		
Others	8.1 Driving control type		DC		
	8.4 Sound level according EN 12053	dB(A)	< 70		